

Quadra Small

The Quadra Small cabinet with sliding doors fits in seamlessly with the modular Quadra cabinet range. The width is variable and is determined by the selected version type.

Frame

- 2 side panels, back, bottom and a plinth on the front.
- The tabletop has straight corners in melaminated chipboard. Thickness: 19 mm.
- The panels are made of melaminated chipboard (thickness: 19 mm).
- The panels are joined together by eccentric cams and dowels.
- The back is milled into a groove in the side panels.
- 4 adjustable synthetic glides.

Interior finishing depends on the chosen type

- 2 detachable shelves (thickness: 19 mm).

Doors and drawers depend on the chosen type

- 2 sliding doors on a sound-dampening rail.
- Metal design handle.

Colours

We would like to refer to our extensive colour gamut.
Sample card + samples available on request.

(*) Option

Dimension

Model Small:

- height: 76 cm
- length: 84 cm
- depth: 45 cm

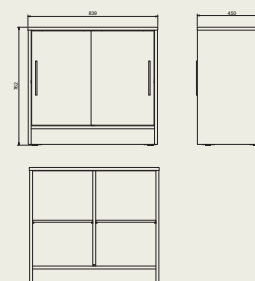

Materials and finishing

- Wood: - chipboard (melaminated, beech veneer (*)).
- Withstands the common cleaning products.

For more information about the **materials, construction and maintenance**: please consult our material lists.

Options

- Finishing in veneer.
- Cylinder lock.
- 4 hidden castors Ø 50 mm.

